

# RECORD of SURVEY BOUNDARY LINE ADJUSTMENT

for  
J. ETHEL CECCHETTINI, Surviving Trustee of  
The Cecchettini Trust dated April 24, 2001  
2008-0004477

BEING A PORTION OF THE NE, SE, SW AND NW 1/4 SECTION 34 AND THE SE, SW AND NW 1/4 SECTION 35, T. 7 N., R. 10 E., M. D. M.  
ALSO BEING A PORTION OF THE NE AND NW 1/4 SECTION 2, T. 6 N., R. 10 E., M. D. M.  
COUNTY OF AMADOR, STATE OF CALIFORNIA



June, 2021

## COUNTY SURVEYOR'S STATEMENT

THIS MAP HAS BEEN EXAMINED IN ACCORDANCE WITH SECTION 8766 OF THE PROFESSIONAL  
LAND SURVEYORS ACT THIS 29<sup>th</sup> DAY OF JUNE, 2021.

  
ROGER R. PITTO PLS 4626  
AMADOR COUNTY SURVEYOR  
MY LICENSE EXPIRES 9-30-2022

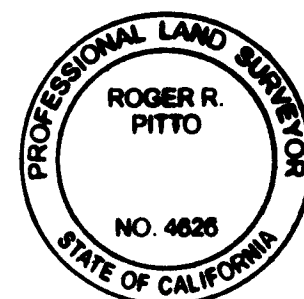

## COMPLIANCE CERTIFICATE

THIS BOUNDARY LINE ADJUSTMENT IS IN COMPLIANCE WITH THE PROVISIONS OF THE  
SUBDIVISION MAP ACT, DIVISION 2 OF TITLE 7 OF THE GOVERNMENT CODE, AND ANY  
APPLICABLE ORDINANCE ENACTED PURSUANT THERETO.

THIS ADJUSTMENT MUST BE COMPLETED IN ALL ASPECTS BY THE 29<sup>th</sup> DAY OF  
JUNE, 2022. THE EXCHANGE OF DEEDS OR COMPLIANCE CERTIFICATES  
MUST BE RECORDED BEFORE THE ABOVE DATE PER ORDINANCE No. 1445, CHAPTER 17.89  
OF THE AMADOR COUNTY CODE.  
DATE: 6/29/2021

  
ROGER R. PITTO PLS 4626  
AMADOR COUNTY SURVEYOR  
MY LICENSE EXPIRES 9-30-2022

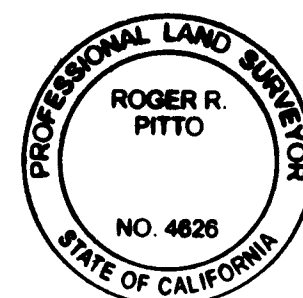

## SURVEYOR'S STATEMENT

THIS MAP CORRECTLY REPRESENTS A SURVEY MADE BY ME OR UNDER MY DIRECTION IN  
CONFORMANCE WITH THE REQUIREMENTS OF THE PROFESSIONAL LAND SURVEYORS ACT  
AT THE REQUEST OF JON LYONS IN APRIL OF 2020.

DATE: June 17, 2021

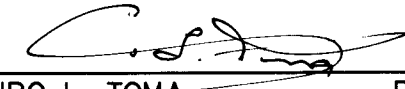
  
CIRO L. TOMA P.L.S. 3570  
MY LICENSE EXPIRES 6-30-2022

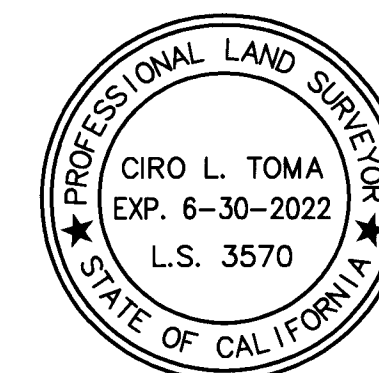

## RECORDER'S STATEMENT

FILED THIS 30<sup>th</sup> DAY OF June, 2021 AT 8:12 A.M.  
IN BOOK 66 OF MAPS AND PLATS AT PAGE 86 AT THE REQUEST OF  
THE AMADOR COUNTY SURVEYOR.

FEE: \$15<sup>00</sup> pdl filed

INSTRUMENT No.: 2021-0007665

  
KIMBERLY L. GRADY  
AMADOR COUNTY RECORDER

BY:   
DEPUTY